



3,290 - 35,857 SF AVAILABLE
FOR LEASE

1650 LAKE
COOK RD





ABOUT THE BUILDING

1650 Lake Cook Rd is a 125,690 RBA building, built in 1995. The proximity to retail, dining and an abundance of other entertainment gives the Deerfield area an urban feel with the convenience of the suburbs.



FEATURES

- 20 Minutes to O'Hare International Airport
- Adjacent to Hyatt Regency Deerfield
- Adjacent to 4-way interchange @ I-294
- On-site management
- Efficient 26,000 rsf floor plates





[CLICK TO](#)
[TOUR](#)
[AMENITIES](#)



Underground
Executive Parking
Grab n' Go Deli
Fitness Center
Daycare on-site

2ND FLOOR



5TH FLOOR

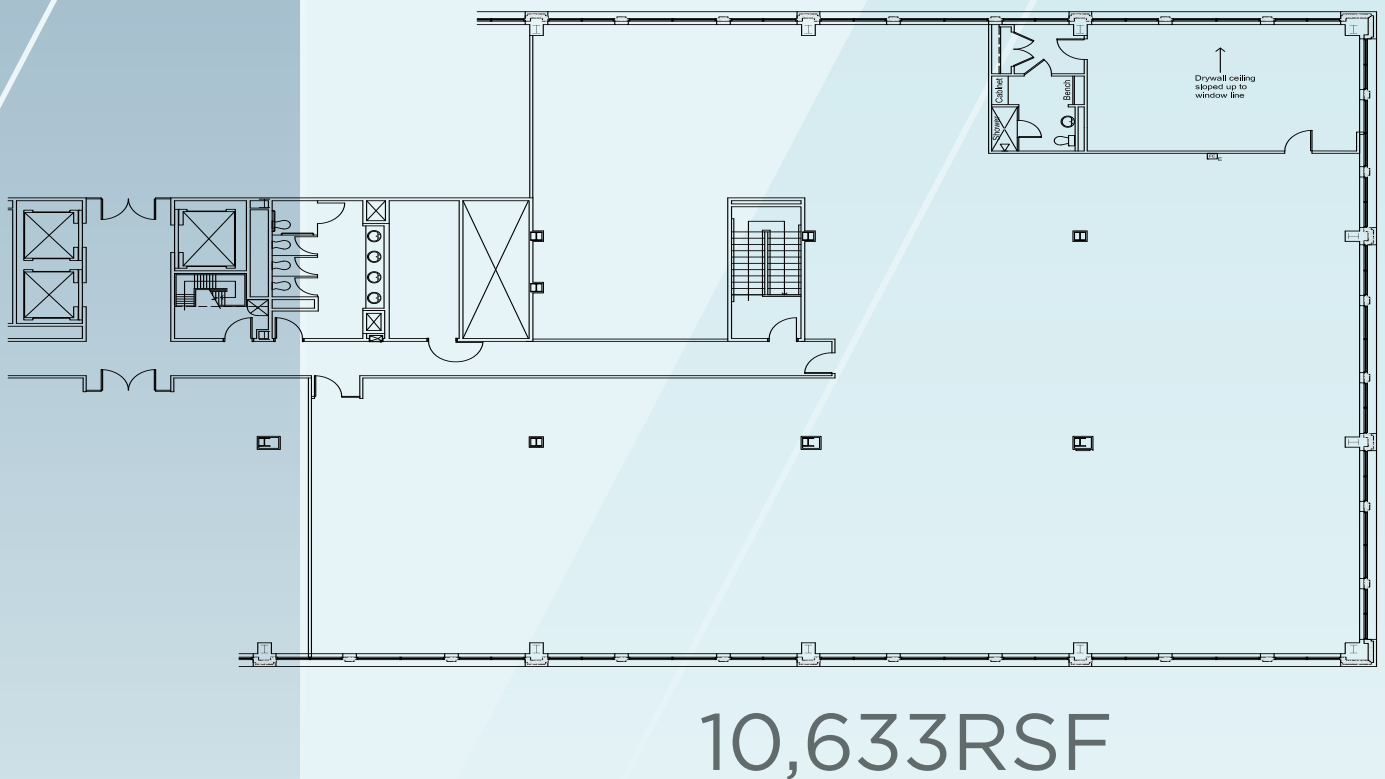

THE LOCATION

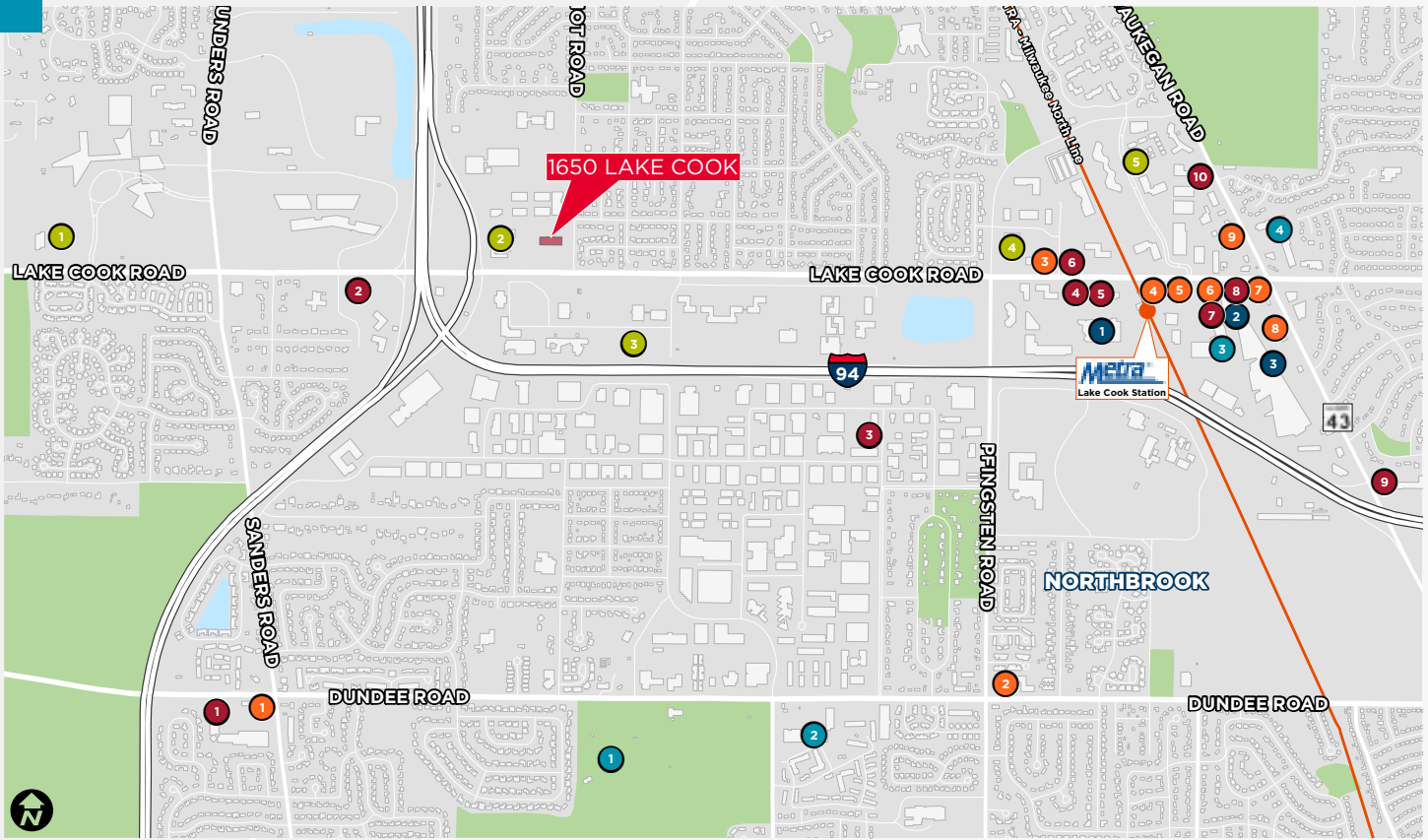

FAST FOOD

- 1 Culver's
- 2 Once Upon a Bagel
- 3 Portillo's
- 4 Jimmy John's
- 5 Dunkin'
- 6 Panera Bread
- 7 Starbucks Coffee
- 8 MOD Pizza
- 9 McDonald's
- 10 Potbelly
- 11 Cafe Zupas
- 12 Chipotle
- 13 Naf Naf Grill

FULL SERVICE DINING

- 1 Butterfield's
- 2 Redland's Grill
- 3 Maestro Seafood & Grill
- 4 McAlister's Deli
- 5 El Tradicional
- 6 Demetri's
- 7 Jimmy Thai
- 8 City Barbeque
- 9 Max & Benny's
- 10 Carson's Prime Steaks
- 11 Parkway Grill
- 12 IL Forno
- 13 Rosebud

14 Bartaco

- 15 Bobby's Deerfield
- 16 Deerfield Italian Kitchen

HOTELS

- 1 Holiday Inn Express
- 2 Hyatt Regency Deerfield
- 3 Embassy Suites
- 4 Courtyard by Marriott
- 5 Residence Inn by Marriott
- 6 Marriott Suites

RECREATION

- 1 Sportsman's Country Club

2 Orangetheory Fitness

- 3 Sachs Recreation Center
- 4 Planet Fitness
- 5 Parkway Athletic Club
- 6 Briarwood Country Club

RETAIL

- 1 The Home Depot
- 2 Jewel-Osco
- 3 Deerbrook Shopping Center
- 4 Whole Foods Market
- 5 Walgreens

5-MILE DEMOGRAPHICS

67,725

\$101,708

46

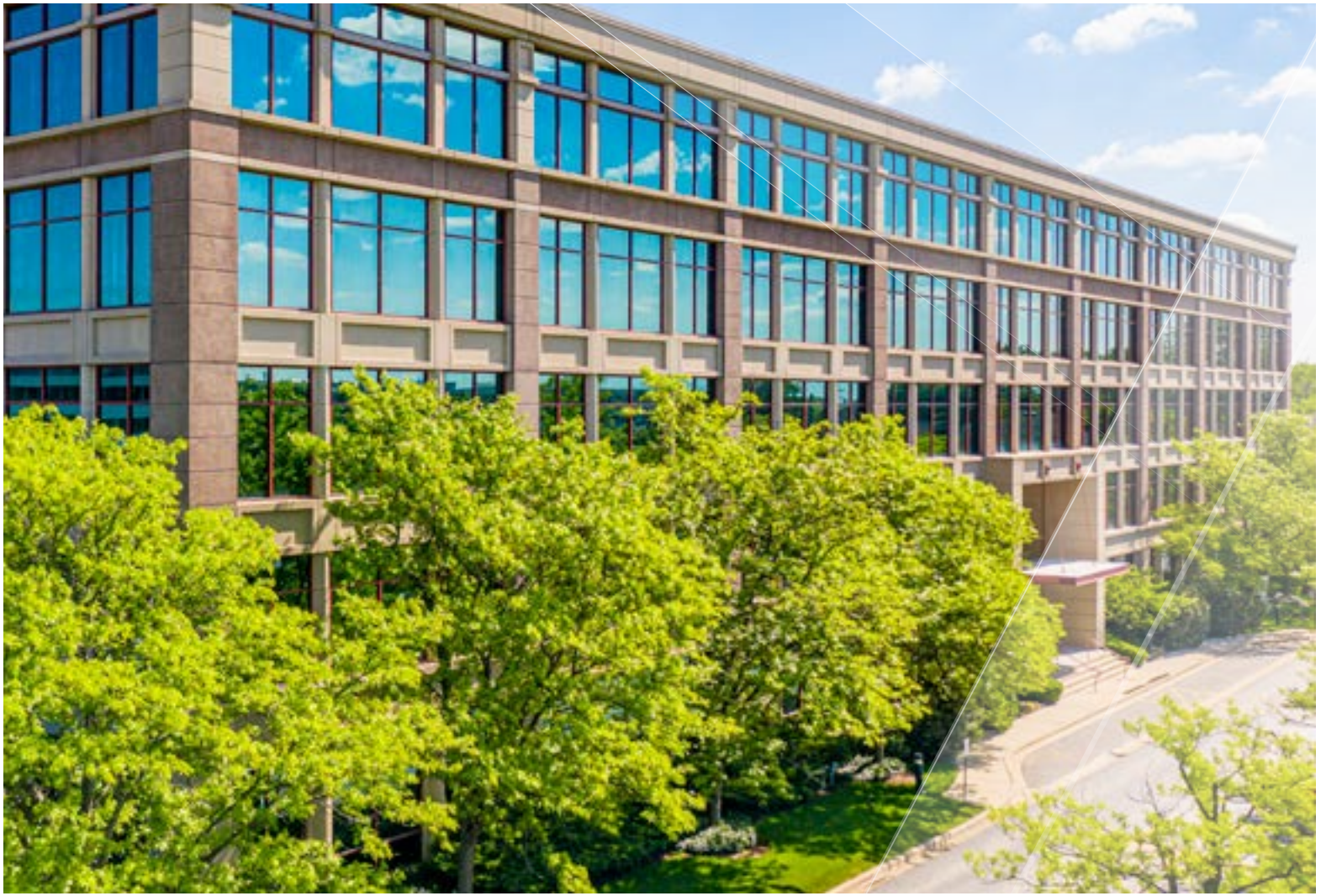

Jim Ward

+1 847 819 5123

jim.ward@cushwake.com

Steve Holmberg

+1 847 302 5180

steven.holmberg@cushwake.com